

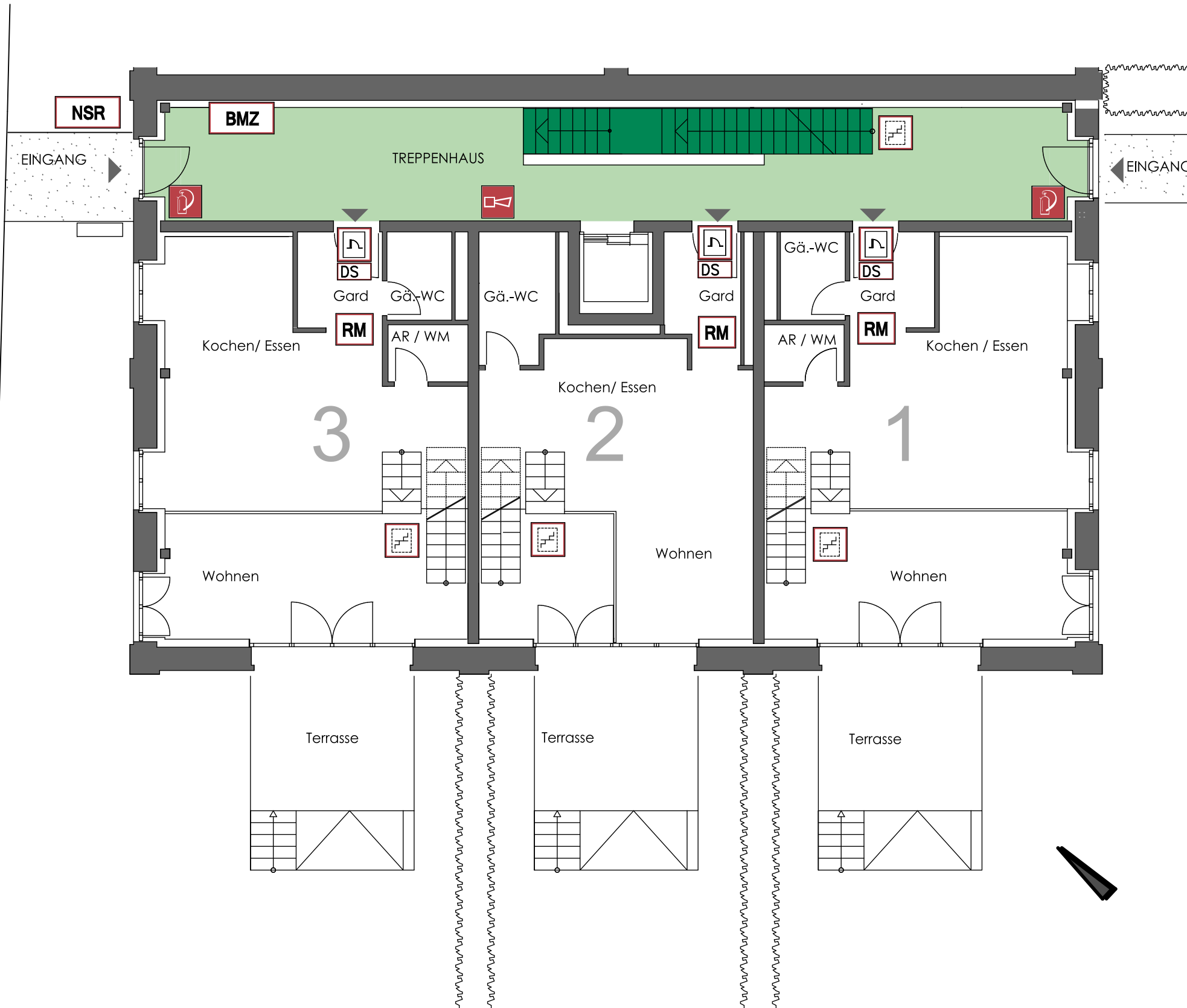









FEUERWEHRPLAN

Alfred-Nobel-Allee



-  FEUERLÖSCHER
-  SIRENE
-  RWA-EINRICHTUNG
-  RWA-BEDIENSTELLE
- BMZ** BRANDMELDEZENTRALE
- NSR** NOTSCHLUSSELROHR
- RM** RAUCHMELDER
-  TREPPE UNGESCHÜTZT
-  NOTAUSGANG
-  HORIZONTALER RETTUNGSWEG
-  VERTIKALER RETTUNGSWEG
-  DICHT- + SELBSTSCHLIESSENDE TUR
- DS**

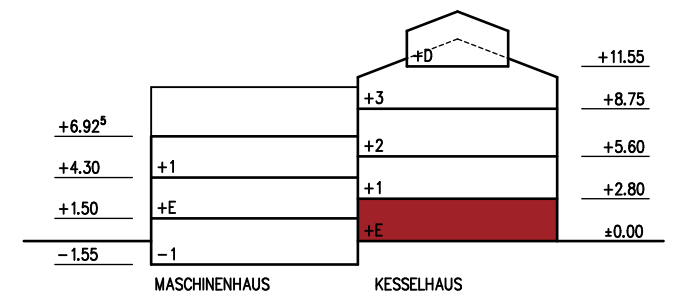

ERDGESCHOSS

MASSSTAB : 1: 100

DATUM 02.05.11